

Product Overview

Canine coronavirus/canine parvovirus (CCV/CPV) is a virus that causes enteritis and vomiting, watery or bloody diarrhea in dogs. WC CCV/CPV Antigen Rapid Diagnostic Test Strip can quickly detect canine coronavirus/canine parvovirus antigen in dog feces by immunochromatography.

Test Principle

A specific antibody to CCV/CPV is immobilized on the detection line (T) of the nitrocellulose membrane, and another specific antibody to CCV/CPV is contained in the colloidal gold particles. As the antigen-antibody complex moves toward the detection line (T) by capillary action, it undergoes a second antigen-antibody reaction with another CCV/CPV-specific antibody in the detection line (T), and turns purple-red, and thus the result is judged.

Materials Provided

CCV/CPV antigen rapid diagnostic test strips contain the following materials:

1. CCV/CPV test strip
2. Bottled buffer solution
3. Buffer solution holder
4. Disposable dripper
5. Sterile cotton swab
6. Instruction manual

Instructions

1. Peel off the sealing film of the buffer solution collection tube and put it into the buffer solution holder;
2. Open the package and take out the test strip, and place it flat on a spacious and dry surface;
3. Collect the dog's feces with a cotton swab at room temperature, insert it into the buffer solution tube immediately, mix it, and squeeze it by hand 5-10 times;
4. Cover the dripper, and slowly add 4 drops of the mixed solution into the sample hole upside down;
5. When the reaction is in progress, a purple-red band can be seen moving in the reaction window in the middle of the test paper;

< Method of Use >

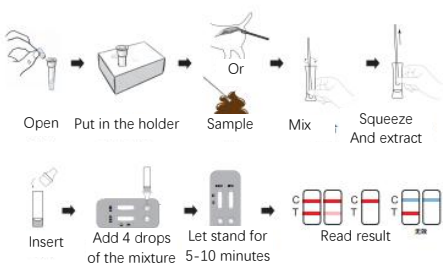

Result Determination

This product determines the result by whether the test line (T) and the control line (C) develop color.

- If the purple-red bands develop in both the control line (C) and the test line (T) indicate that the test sample contains CCV/CPV antigen, as shown in Figure 1);
- If the test line (T) does not develop color, it means that the test sample does not contain CCV/CPV antigen, as shown in Figure 2);
- If the control line (C) is blue, it means that the operation process is incorrect or the test card is invalid, please test again, as shown in Figure 3).

1) Positive result

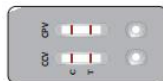

2) Negative result



3) Invalid result



The color shade of the purple-red line at the test line (T) is directly related to the CCV/CPV antigen content in the test object. When the antigen content in the test substance is high, the line at the test line (T) may appear, and then the purple-red may gradually fade or even disappear. At this time, it is recommended to dilute the sample by 10 times before testing.

Precautions

1. Only for veterinary diagnosis;
2. Do not ingest food or smoke when collecting samples;
3. This product is very sensitive to humidity, so pay attention to the decline in function caused by humidity;
4. When taking out the product, avoid touching the detection line with hands or other foreign objects;
5. Avoid being infected by unknown viruses when collecting samples;
6. Wear disposable gloves when collecting potentially infectious substances, and wash your hands afterwards;
7. When using, pay attention to repeated freezing and thawing may cause false negative or false positive;
8. Test samples used within 3 days need to be stored at 2-8°C, and those used for more than 3 days need to be frozen at -20°C.

Test Limitation

Even if the WC test strip can accurately detect CCV/CPV antigen, there may be chance for false positives and false negatives. Therefore, it is necessary to combine the test results with clinical symptoms and make a comprehensive judgment based on the doctor's experience.

Preservation and Valid Period

Store airtight at room temperature (2-30 °C), do not freeze. Valid for 24 months from date of manufacture.